

# KITCHEN

## AND BATH IDEAS

Refrigerator  
Buying  
Guide

p. 27

# Get Inspired!

## 17 Fresh Looks

How to Update  
a Basic Bath p. 130

# 79 EXPERT TIPS:

- Add Color Where It Counts
- Customize Your Island
- Create an Eat-In Kitchen

April 2012  
Display until April 10



\$6.99 US

BHG.com/kitchenbath

# SEASIDE CHIC

This beach-house bath was more bland than grand until an astute professional helped turn the tide.

*writer* WENDY GRAY *photographer* LAURA MOSS *field editor* LAUREN PAYNE

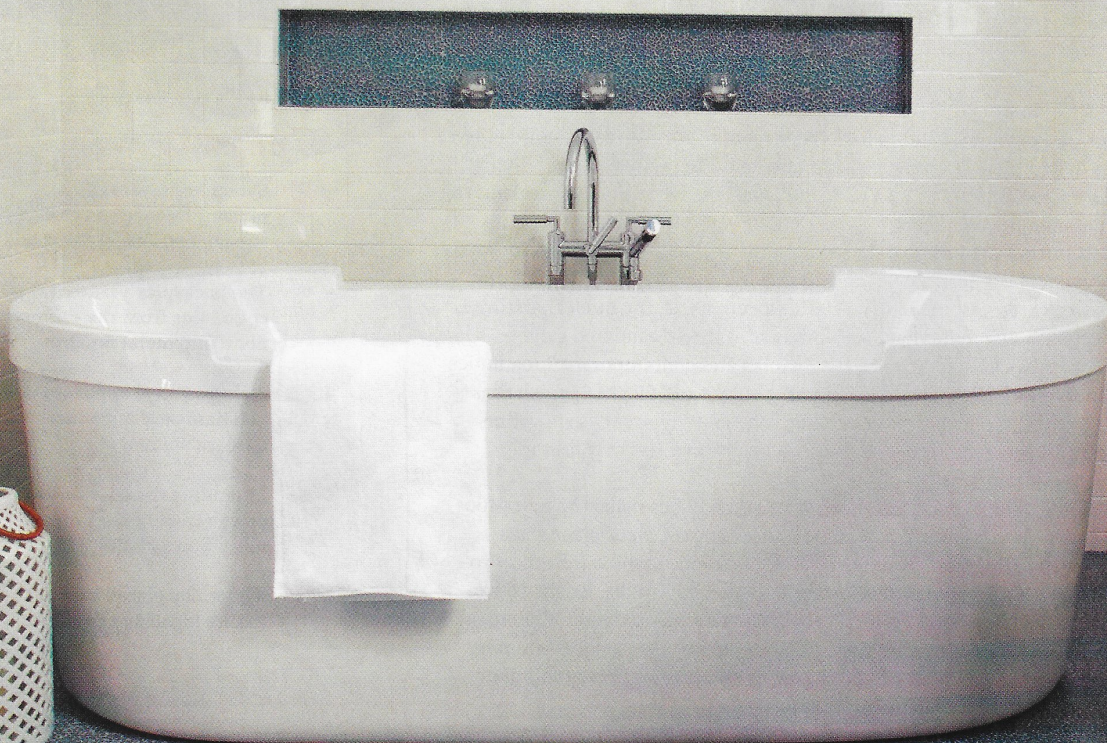



**OPPOSITE:** The subtle alcove created by the angled ceiling is an ideal spot for a sleek new tub. **THIS PHOTO:** Handmade in France, this chartreuse crystal chandelier brings unexpected elegance, tradition, and color to the cool, modern surroundings.

**COLOR COMBOS FOR EVERY STYLE**

See 20 inspiring bath color schemes that fit in any home. [BHG.com/bathcolors](http://BHG.com/bathcolors)





# NEVER BACK DOWN

**OPPOSITE:** The twin sinks are elevated to seem less imposing while simultaneously anchoring the new window wall with rich substance. **ABOVE:** A window in the glass-enclosed walk-in shower provides additional natural light.

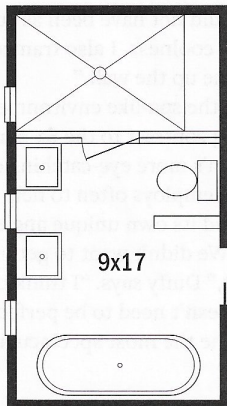

from a challenge. That's designer Jules Duffy's philosophy. And this 1970s (think *Brady Bunch*) home in Bay Head, New Jersey, presented just that. "The homeowners and I analyzed the original master bathroom, and after drafting several floor plans, we realized there was nothing worth retaining—including the window placement and closets," Duffy says. "Working with a raw space gave me complete creative freedom to craft the perfect spa bath."

Because the bath is in a beach house, the homeowners wanted the design to be as airy-feeling as possible and to feed additional light into the master bedroom. Now, an east-facing window wall floods the space with bright sunlight. A sliding, frosted-glass barn door separates the master bedroom and bath, allowing natural light through without compromising privacy. Because it does not swing into either room, the door also saves space.

Duffy created a modern feel by minimizing the palette, using strategic splashes of color for elegance and emphasis against a stark white backdrop. "The dual sinks are like jewelry on the walls. The fact that they 'float' helps reduce their bulk and accentuates the contrast of the blue mosaic floor,"

## Takeaways

- 1** Low-cost materials, such as field tile, leave room in your budget for more expensive amenities.
- 2** Incorporating existing architectural elements into the design adds character.
- 3** Dark wood balances the cool tones of the wall, flooring, and plumbing fixtures.
- 4** A signature light fixture can elevate the look of any bathroom.
- 5** Windows placed high on a bathroom wall bring in natural light without sacrificing privacy.



**OPPOSITE:** White subway tile throughout the bath offers a cohesive look at an affordable price. **ABOVE:** Cross handles on this streamlined faucet add a touch of traditional style to the modern fixture. **ABOVE RIGHT:** For added privacy, Duffy placed a half-wall on one side of the toilet.

Duffy says. “The bathroom would not have been as successful without warm wood breaking up the tile’s icy coolness. I also framed the inset mirrors with dark walnut to continue the line up the wall.”

Adding unexpected swag in the spa-like environment, an ornate chandelier tops the space and is in striking contrast to the \$3-per-square-foot subway tile Duffy chose to ground the room’s more eye-catching elements. Duffy calls that tile her secret weapon, one she employs often to help keep projects on budget.

The 9×17-foot space also had its own unique angle—a slanted ceiling that follows the home’s roofline. “We didn’t want to get into a major structural remodel, so we worked with it,” Duffy says. “I think the angle actually makes it more interesting. A space doesn’t need to be perfect to succeed. Often the most challenging spaces become the most spectacular.” **KBI**

RESOURCES BEGIN ON PAGE 134.

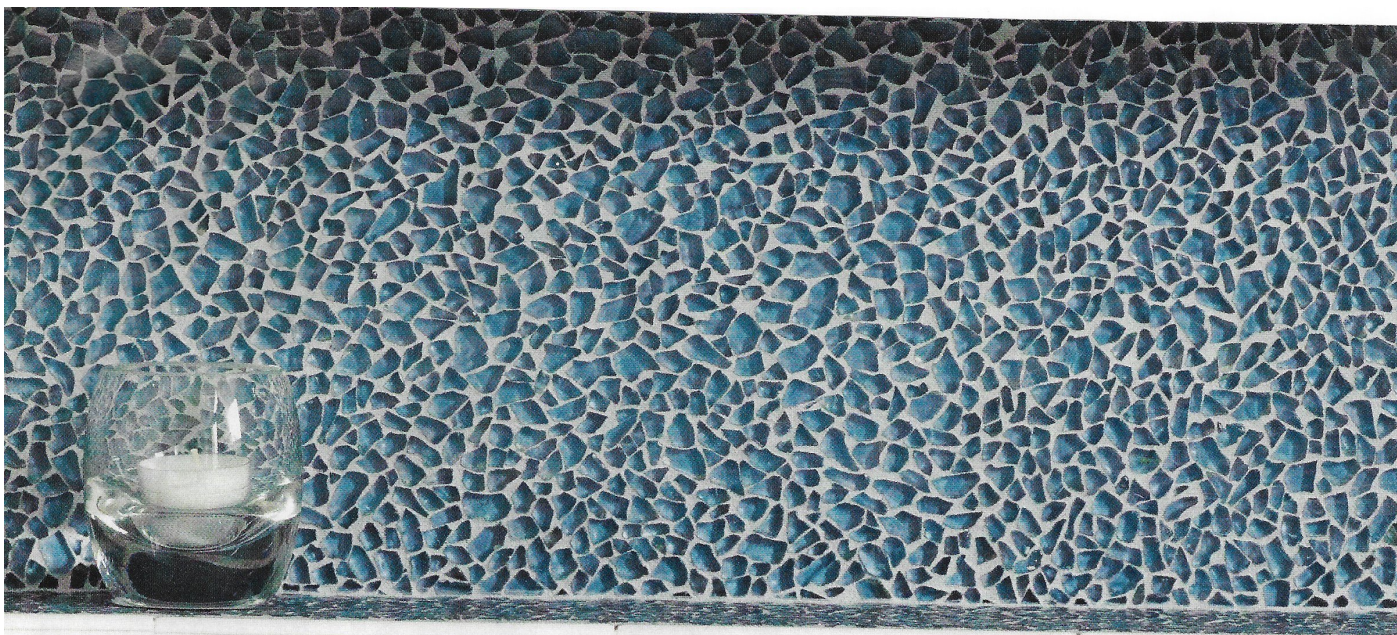

“A space doesn’t need to be perfect to succeed. Often the most challenging spaces become the most spectacular.”

Jules Duffy  
designer

